

## Gravity Filter

### Installation Guide and Technical Information

Thank you for purchasing a Gravity Filter system. Your Gravity Filter comprises an upper chamber where the filter cartridges are located and a lower chamber where the purified water is stored.

The GS2 has two filter cartridges and the GS4 has four filter cartridges. The more filter cartridges your gravity filter system has, the faster the flow and the higher the volume of purified water. Your purchase of a Water Filter will help protect you from water borne disease. The filter uses ceramic filter cartridges, which trap pathogenic bacteria – the main causes of diseases such as dysentery, cholera, bilharzia and typhoid, etc.

It is important that anyone using a filter system takes time to study this guide as it contains essential information needed to ensure easy installation and trouble-free use.

Follow the instructions and, after installation, your system will produce purified water.

Keep this guide in a safe place. It will enable you to get the best performance from your system now and in the future.

<b>Section One</b>	<b>Principal components</b>
<b>Section Two</b>	<b>Installation</b>
<b>Section Three</b>	<b>Operating instructions and Maintenance</b>
<b>Section Four</b>	<b>General information</b>

Gravity Filter  
fig.1

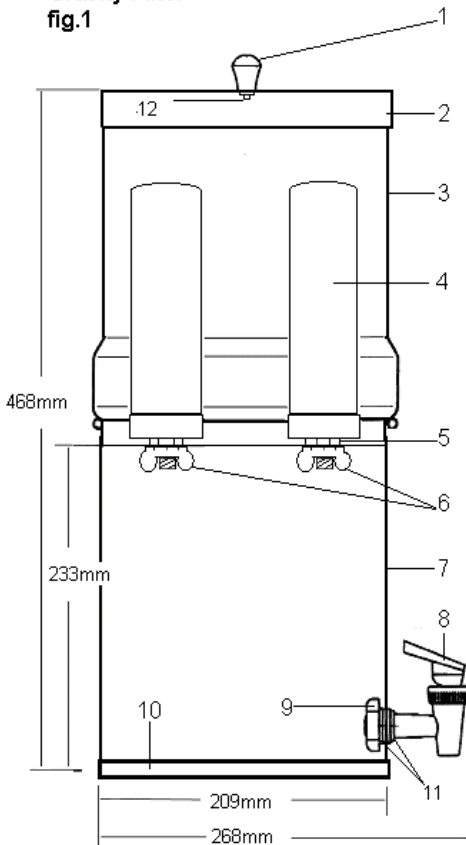

FL.12.CP17  
fig.2

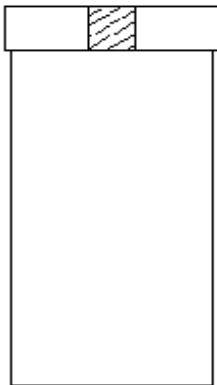

## Section one Principal components

(Figs 1)

The first component in the system is the lid knob (1) and is connected to the lid (2). The upper housing (3) sits on top of the lower housing (7). The cartridges (4) fit into the holes in the upper housing (3) and are held in place by the wing nuts (6) and washers (5). The tap is connected to the lower housing (7) and is fastened with tap nut (9) and washers (11). The final component is the non-slip rubber ring (10).

An optional cartridge (fig.2) for fluoride removal can be used in place of the wing nuts to fasten the top cartridges (4).

## Section Two Assembly Details

1. Remove the filter housings and ceramic candles from the packaging and check each item against the sketch shown. This will enable you to assemble the filter with the minimum of effort. (Please Note: the number of candles supplied will depend on the filter model purchased. For instance, Filter Model GS2 is supplied with 2 candles and a GS4 is supplied with 4 candles.

2. Since cleanliness is important ensure that contamination of the filter components does not occur during assembly of the Water Filter.

Fit KNOB (1) onto the LID (2) and insert SCREW (12) through the hole in the LID (2) screw on the KNOB (1) by hand only.

3. Push the sealing WASHER (5) over the threaded section of the CANDLE (4) MOUNT.

4. Place the CANDLE/S (4) into the holes in the UPPER SECTION (3). Secure the CANDLE/S into the UPPER SECTION (3) by screwing the CANDLE WING NUT (6) onto the threaded candle mount from underneath the upper section.

### warning

Push one WASHER (11) over the thread of the TAP (8) and secure the TAP into the hole provided in the BOTTOM SECTION (7) with the other WASHER (11) and the NUT (9).

5. Place the UPPER SECTION (complete with candles and LID) onto the BOTTOM SECTION (7). Fit the NON SLIP/ANTI-CONDENSATION RUBBER RING (10) on to the lower section.

Ensure the TAP (8) IS IN THE "OFF" position and fill the UPPER SECTION (3) with water. The water from the upper section will now filter through the ceramic candles into the bottom section giving you clean drinking water.

Discard the first batch of purified water, this will have flushed the cartridges.

## Section three

### Maintenance

When you have assembled the filter as shown the only maintenance required is the periodic cleaning of the filter candles. To clean the filter candles we would suggest the following procedure.

1. Remove the candle/s (4) from the upper section (3) by unscrewing the wing nut (6) making sure you keep the washer (5) in a safe place for refitting later.
2. Hold the filter candle under running water or in a bowl of water and clean the ceramic portion of the candle with a stiff brush ensuring that no water or contamination is allowed to enter the out-let hole in the threaded portion of the candle mount. Always brush the candle in the direction away from the candle mount.

**DO NOT USE SOAP, DETERGENTS OR BLEACH WHEN CLEANING THE FILTER CANDLE.**

We suggest that the filter candles are replaced at 12 monthly intervals.

**Warning:** In some cases the Cartridge media can become lodged at one end. Upon contact with water this media will expand and can split the cartridge. To prevent this, shake cartridge horizontally before use

### Sanitising the system

1. Place 3 'Puritabs' disinfecting tablets in the upper housing with the cartridge(s)
2. Fill the system with water.
3. Allow to stand for 40 minutes.
4. Now empty the upper housing.

### Going on holiday

If you go away for a holiday or are away for a few days, it is recommended practice to turn off the household mains water, whether or not you have a ItDoesTheJob.com system. When you return, fill the system with water and let it flush through the Cartridges to ensure your next batch of water will be pure and fresh.

If you are taking your Gravity Filter with you on holiday it is advisable to take spare cartridges in case of any breakages.

## Section four

### General information

#### 1: Useful tips

With just the minimum of maintenance and attention your ItDoesTheJob.com high quality water purification system will give you many years of excellent service. The following tips may be useful:

- a. NEVER keep the filter where the water can freeze, as this will break the ceramic and may damage the seals.
- b. Check the filter regularly for water leaks as these may indicate faulty installation or maintenance.
- c. Read this user guide carefully and keep it in a safe place.
- d. For optimum performance clean and replace the filters regularly in accordance with the instructions.

#### 2: Fault finding

If you have any difficulty in installing the filter or maintaining the filter you may find the following useful:

##### 2.1) No Water

- a) Check that the dispenser tap is open
- b) Ceramic filter elements may be blocked with sediments, take out filters and clean.

##### 2.2) Low water flow

- a) Check that you have removed all the wrapping from a new filter cartridge.
- b) During use, low water flow may be an indication that the filter is becoming blocked as it collects the unwanted debris and pollutants from the water. (See cleaning instructions, Section Three, Step 2.)
- c) If the flow does not return to its former level immediately after cleaning the ceramic cartridge will probably need replacement.

**For more information call; 020 8539 4707**